

# HySense® TE 3xx

The **HySense® TE 3xx** series is perfect for carrying out temperature measurements on liquids and gases in closed systems. It features a wide variety of available electrical and mechanical connections, making it easy to quickly integrate the devices into systems – a characteristic that is further enhanced by the fact that both the probe length and the probe diameter can be individually configured. The main characteristic behind these temperature sensors, however, is their superior durability and strength – a million pressure changes at up to 600 bar are no problem. All this makes the **HySense® TE 3xx** the perfect temperature sensors for any hydraulic application.

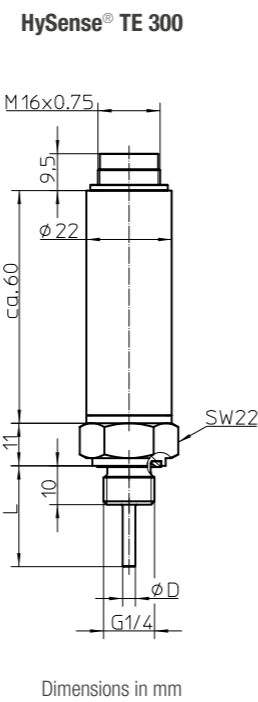

Electrical connectors			
M12 x 1, 4-pin	M16 x 0.75, 6-pin	AMP DIN 72585, 3-pin	Type C valve connector, 3-pin Pg9

Dimensions in mm

Mechanical connections			
M10 x 1	ISO 228-G 1/4	MINIMESS® p/T direct sensor adapter	NPTF 1/4

Dimensions in mm

General characteristics	
Sensor principle	Pt100
Measuring range	-50 ... 200 °C
Output signal	4 ... 20 mA, ISDS, 0 ... 10 VDC*
Mechanical measuring connection	M10 x 1 ISO 228-G 1/4 NPTF 1/4 MINIMESS® 1620 & 1615* p/T test point direct sensor adapter
Electrical measuring connector	M12 x 1, 4-pin M16 x 0.75, 6-pin Type C valve connector, 3-pin Pg9 AMP DIN 72585, 3-pin*
Probe length	20 ... 400 mm*
Probe diameter	2 ... 6 mm*
Measuring accuracy	0.3 +0.005*T °C
Transducer nonlinearity	±0.2% of full scale
Ambient temperature	-40 ... 85 °C
Weight	Approx. 140 g (depends on the version)
IP degree of protection	IP67 and IP69 (DIN EN 60529)

\* More available upon request

Sensor	Measuring range	Electrical connector	Output signal	Mechanical connection	Probe length	Probe diameter	Part No.
	C°				mm	mm	
TE 300	-50 ... 200	M16 x 0.75 6-pin	4 ... 20 mA, ISDS	MINIMESS® 1620 p/T test point direct sensor adapter	–	2	3408-22D0-D631Z1S
				MINIMESS® 1615 p/T test point direct sensor adapter	–	2	3408-22D0-D731Z1S
				ISO 228-G 1/4	26	3.3	3408-23C0-G231Z1S
				M10 x 1	20	4	3408-2410-M331Z1S

Sensor	Measuring range	Electrical connector	Output signal	Mechanical connection	Probe length	Probe diameter	Part No.
	C°				mm	mm	
TE 330	-50 ... 200	M12 x 1, 4-pin	0 ... 10 VDC	MINIMESS® 1620 p/T test point direct sensor adapter	–	2	3408-22D0-D611D47
			4 ... 20 mA	MINIMESS® 1620 p/T test point direct sensor adapter	–	2	3408-22D0-D611Z13
			0 ... 10 VDC	ISO 228-G 1/4*	26	3.3	3408-23C0-G211D47
			4 ... 20 mA	ISO 228-G 1/4*	26	3.3	3408-23C0-G211Z13
			0 ... 10 VDC	ISO 228-G 1/4	20	4	3408-2410-G211D47
			4 ... 20 mA	ISO 228-G 1/4	40	4	3408-2420-G211Z13
			0 ... 10 VDC	M10 x 1	60	4	3408-2430-M311D47
			4 ... 20 mA	ISO 228-G 1/4	250	4	3408-2470-G211Z13
			4 ... 20 mA	ISO 228-G 1/4	200	6	3408-2660-G211Z13

\* Substitute for MINIMESS® p/T test point

Sensor	Measuring range	Electrical connector	Output signal	Mechanical connection	Probe length	Probe diameter	Part No.
	C°				mm	mm	
TE 350	-50 ... 200	Type C valve connector, 3-pin Pg9	4 ... 20 mA	ISO 228-G 1/4	26	3.3	3408-23C0-G2C3Z11

Sensor	Measuring range	Electrical connector	Output signal	Mechanical connection	Probe length	Probe diameter	Part No.
	C°				mm	mm	
TE 380	-50 ... 200	AMP DIN 72585, 3-pin	4 ... 20 mA	MINIMESS® 1620 p/T test point direct sensor adapter	–	2	3408-22D0-D6R1Z12



ICS Schneider Messtechnik GmbH  
 Briesestraße 59  
 D-16562 Hohen Neuendorf / OT Bergfelde

Tel.: 03303 / 50 40 66  
 Fax: 03303 / 50 40 68

info@ics-schneider.de  
 www.ics-schneider.de