

Compression force transducer Miniature design to 1,000 N Model F1814

WIKA data sheet FO 51.57

EAC

Applications

- Equipment manufacturing, production lines
- Measuring and control systems
- Precision engineering
- Materials testing machinery
- Laboratory

Special features

- Measuring ranges 0 ... 50 N to 0 ... 1,000 N
- Relative linearity error 1 % F_{nom}
- Stainless steel or aluminium version
- Low installation height, easy to install
- Ingress protection IP64



Miniature compression force transducer, model F1814

Description

The model F1814 miniature compression force transducer, with measuring ranges to 1,000 N, is particularly suitable for use in areas where installation space is critical.

Due to its very small dimensions and solid construction, this miniature force transducer, manufactured from stainless steel or aluminium, can be used in the widest range of industrial areas, in test facilities and in the laboratory..

Specifications per VDI/VDE/DKD 2638

Model F1814						
Rated force F_{nom} N	50	100	200	300	500	1,000
Rated force F_{nom} lbf	11.24	22.5	45	67.44	112	225
Relative linearity error d_{lin}	1 % F_{nom}					
Relative reversibility error v	0.5 % F_{nom}					
Relative span in unchanged mounting situation b_{rg}	0.5 % F_{nom}					
Limit force F_L	120 % F_{nom}					
Breaking force F_B	150 % F_{nom}					
Material of the measuring body						
30 N	Aluminium					
≥ 50 N	Stainless steel					
Service temperature range $B_{T, G}$	-20 ... +80 °C [-68 ... +176 °F]					
Input resistance R_e	1,030 ±80 Ω					
Output resistance R_a	1,030 ±80 Ω					
Insulation resistance R_{is}	≥ 5,000 MΩ/DC 100 V					
Output signal (rated characteristic value) C_{nom}	1.0 ±0.1 mV/V					
Electrical connection	Cable Ø 2 × 3,000 mm [Ø 0.1 in x 118 in]					
Voltage supply	DC 5 V (max. 7 V)					
Ingress protection (per IEC/EN 60529)	IP64					
Weight	0.1 kg [0.22 lbs]					

Approvals

Logo	Description	Country
	EU Declaration of Conformity <ul style="list-style-type: none"> ■ EMC Directive ■ RoHS Directive 	European Union
	EAC (Option) EMV-Directive	Eurasian Economic Community

Dimensions in mm [in]

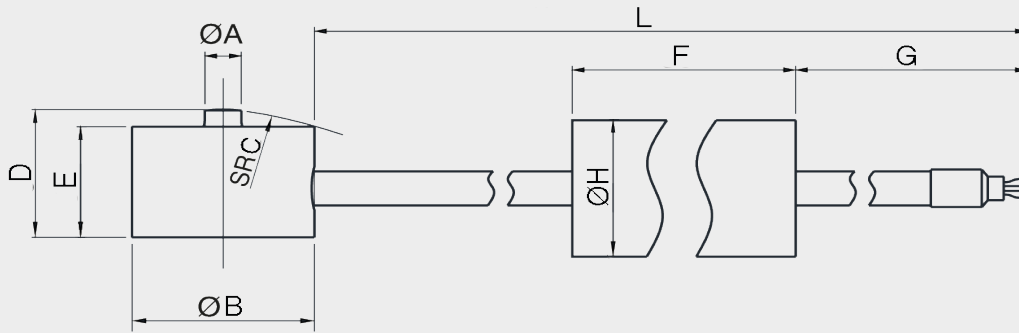

SR = spherical radius

Rated force in N [lbf]	Dimensions in mm [in]								
	ØA	ØB	SR C	D	E	F	G	ØH	L
50 [11.24] / 100 [22.5]	1.5 [0.06]	10 [0.39]	5 [0.19]	6 [0.24]	5.2 [0.20]	50 [1.97]	150 [5.90]	8 [0.31]	3,000 [118]
200 [45] / 300 [67.44]	2 [0.08]	10 [0.39]	8 [0.31]	6 [0.24]	5.2 [0.20]	50 [1.97]	150 [5.90]	8 [0.31]	3,000 [118]
500 [112] / 1,000 [225]	2.5 [0.1]	10 [0.39]	10 [0.39]	6 [0.24]	5.2 [0.20]	50 [1.97]	150 [5.90]	8 [0.31]	3,000 [118]

Pin assignment

Electrical connection	
Excitation voltage (+)	Red
Excitation voltage (-)	Black
Signal (+)	Green
Signal (-)	White
Shield ⊕	Shield

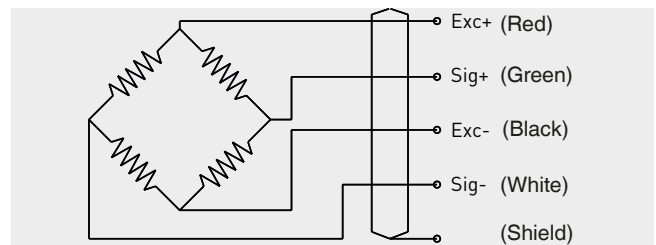

© 08/2019 WIKA Alexander Wiegand SE & Co. KG, all rights reserved.
The specifications given in this document represent the state of engineering at the time of publishing.
We reserve the right to make modifications to the specifications and materials.