

HySense® PR 1xx

HySense® PR 1xx is the Hydrotechnik standard in the area of pressure measurement. These pressure sensors are perfect for both temporary diagnostic tasks and for stationary measuring tasks such as condition monitoring and predictive maintenance. Excellent strength, a wide measuring range of -1 to 2500 bar, and a wide variety of available versions make these pressure sensors all-rounders in every sense of the word.

General HySense® PR 1xx characteristics	
Sensor principle	Piezoresistivity
Pressure type	Relative pressure*
Measuring accuracy with ISDS @ 25 °C	±0.2% of full scale
Measuring accuracy without ISDS @ 25 °C	±0.5% of full scale
Overload range	2 x rated pressure (≤ 200 bar) 1.5 x rated pressure (> 200 ... 500 bar) 1.2 x rated pressure (> 500 ... 2000 bar)
Burst pressure	3 x rated pressure (≤ 200 bar) 2 x rated pressure (> 200 ... 500 bar) 1.5 x rated pressure (> 500 ... 2000 bar)
Body material	Stainless steel
Diaphragm material	Stainless steel or silicon
Sampling rate	1 kHz
Fluid temperature	-40 ... 125 °C
Ambient temperature	-40 ... 105 °C
Installation position	Any

* More available upon request

HySense® PR 100

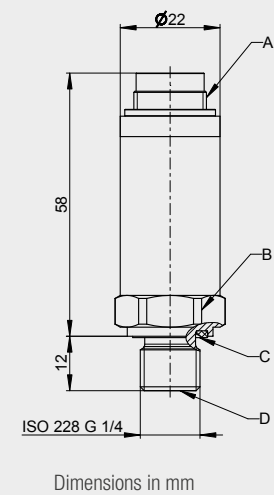

A	M16 x 0.75, 6-pin
B	AF 22
C	ED seal in conformity with DIN 3869, FKM



Characteristics	
Output signal	4 ... 20 mA, ISDS
Electrical connector	M16 x 0.75, 6-pin
Mechanical connection	ISO 228-G 1/4
IP degree of protection	IP67 (DIN EN 60529)
Weight	80 ... 100 g (depending on the version)

Measuring range* bar	Color coding	Part No.
-1 ... 6	Red	3403-32-S-E5.37
0 ... 60	Orange	3403-21-S-E5.37
0 ... 250	Yellow	3403-17-S-E5.37
0 ... 400	Blue	3403-15-S-E5.37
0 ... 600	Green	3403-18-S-E5.37
0 ... 1000	—	3403-29-S-E5.37

* More available upon request